

## Material Submission Form (E&M Works)

**Project : Modernization of Aberdeen Market cum Cooked Food Centre**

Submit To: Percy Thomas Partnership (HK) Ltd.  
 Attn.: Mr. Terry Lau  
 Submission No: 2021-020/MS/EM/EL/009 Project No : 2021-020  
 Submission Date: 24 Sep 2021

**Details of Submission**

The enclosed sample\*/catalogue\*/technical data\* as described below have been checked for compliance with Specification & Drawings, and herewith submitted for approval.

A) Materials Description & Trade: Cable Trunking & Accessories / Electrical  
 B) Specification Ref. Page: G.S. C2.4  
 C) Dwg. Ref. No: BS/8523/EE021 - EE025  
 D) Location: All areas  
 E) Brand Name & Model: Kam Tai  
 F) Manufacturer: Kam Tai product (H.K.) Co., Ltd.  
 G) Country of Origin: RPC  
 H) Supplier: Kam Tai product (H.K.) Co., Ltd.  
 I) Catalogue: As attached  
 J) Technical Data: As attached  
 K) Test Report / Cert. As attached  
 L) Job References: As attached  
 M) Remarks: --  
 N) Expected Approval Date: 7-Oct-21

For and on behalf of Ray On Construction Co., Ltd.

P. P. J. Wong  
 C. F. Wong Associate Director

\* Delete as appropriate

To: Ray On Construction Co. Ltd.  
 From: Percy Thomas Partnership (HK) Ltd.

On the basis of the sample & information given, the above sample submitted is:

- 1) \* Approved  
 2) \* Approved subject to \_\_\_\_\_  
 3) \* Not approved because \_\_\_\_\_ and resubmission is required

**Remarks:**

Approval does not alter the requirement of the contract unless specifically noted.

\* Representative Signature:

\_\_\_\_\_  
 Date : \_\_\_\_\_ Position

\* Delete as appropriate

c.c. Arch SD - Mr. Tse Lok Man, Alex / Mr. K.K. Wu	w/e	<input checked="" type="checkbox"/>	w/o	<input type="checkbox"/>
Arch SD - Mr. K.H. Nip, Alan	w/e	<input type="checkbox"/>	w/o	<input type="checkbox"/>
Arch SD - Mr. Y.K. Chu / Mr. Kuo Kuo Chen, Alan	w/e	<input checked="" type="checkbox"/>	w/o	<input type="checkbox"/>
Arch SD - Mr. C.H. Wong	w/e	<input checked="" type="checkbox"/>	w/o	<input type="checkbox"/>
Arch SD - Ms. Lam Lai Kuen, Ami / Mr. Kelvin Fu	w/e	<input type="checkbox"/>	w/o	<input type="checkbox"/>
PTP - Mr. Eric Yau	w/e	<input checked="" type="checkbox"/>	w/o	<input type="checkbox"/>
PBSI - Mr. C.M. Lam	w/e	<input checked="" type="checkbox"/>	w/o	<input type="checkbox"/>
CANWEST - Mr. Mark Yu	w/e	<input type="checkbox"/>	w/o	<input type="checkbox"/>
TALENT - Mr. Patrick Chu / Mr. H.K. Chou	w/e	<input checked="" type="checkbox"/>	w/o	<input type="checkbox"/>
BCL - Mr. Kam Lee / Ms. Nicole Wong	w/e	<input type="checkbox"/>	w/o	<input type="checkbox"/>
Che Luen - Mr. William Shum / Mr. Alen Chiu / Mr. Roy Li	w/e	<input checked="" type="checkbox"/>	w/o	<input type="checkbox"/>

# EL-09 Cable Trunking & Accessories (Rev.0)



## Cable Trunking 電線槽

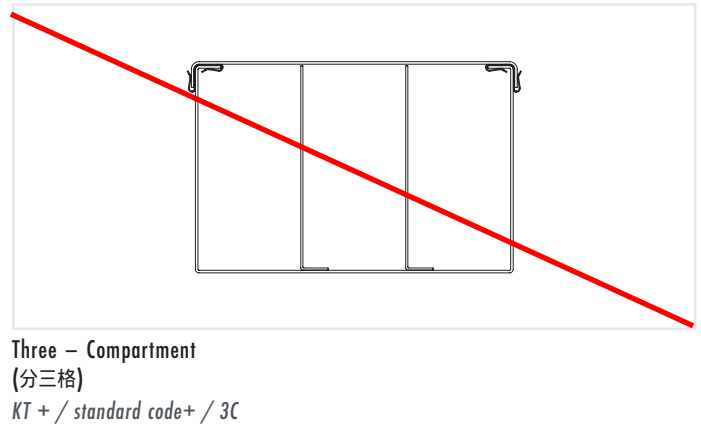
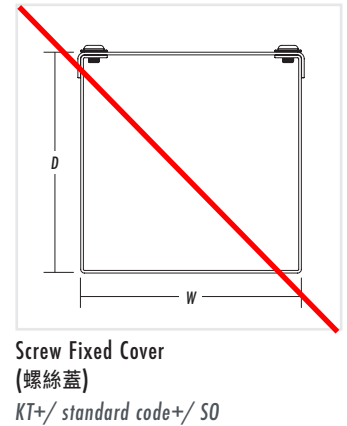
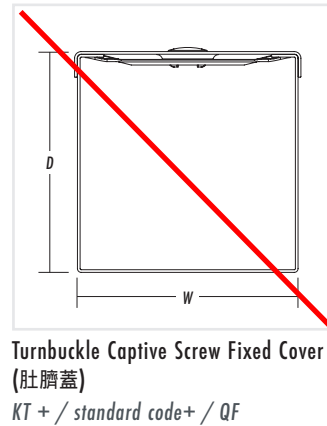
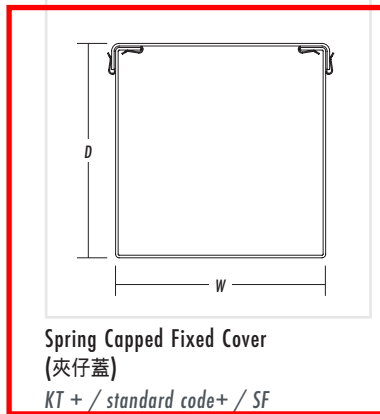

### Technical Specification:

- BS EN50085-1 or IEC61084-1
- Each length supplied with cover, coupler, tinned earth link and fixing screws.
- Standard length is 2.44m/ Non standard thickness and finishes available to clients order.
- Customize size is available for order upon request.

### Materials Standard:

- Galvanized Steel Sheet to BS4678  
Part 1: Class 3 Protection to BS EN10143  
(Coating Mass 275g/m<sup>2</sup>)  
Standard product code +/GI
- Mild Steel Sheet to BS1449-1 or BS EN10149-1 finished in Hot-dipped Galvanized after Perforation to ISO1461  
Standard product code +/HDG
- Stainless Steel to Grade 304 or Grade 316  
Standard product code +/SS304 or +/SS316
- Other Material or Coating:
  - Aluminum Steel Sheet
  - Plastic Coated
  - Epoxy / Polyester Powder Coated

Standard Size (mm) W x D	Available Material Thickness (mm)	Standard Code
50 x 50	1.0 / 1.2 / 1.4 / 1/6	5050
75 x 50	1.2 / 1.4 / 1.6	7550
75 x 75	1.2 / 1.4 / 1.6	7575
100 x 50	1.2 / 1.4 / 1.6	1050
100 x 75	1.2 / 1.4 / 1.6	1075
100 x 100	1.2 / 1.4 / 1.6	1010
150 x 50	1.2 / 1.4 / 1.6	1550
150 x 75	1.2 / 1.4 / 1.6 / 1.8	1575
150 x 100	1.2 / 1.4 / 1.6 / 1.8	1510
150 x 150	1.2 / 1.4 / 1.6 / 1.8	1515
200 x 50	1.2 / 1.4 / 1.6 / 1.8	2050
200 x 75	1.2 / 1.4 / 1.6 / 1.8	2075
200 x 100	1.2 / 1.4 / 1.6 / 1.8	2010
200 x 150	1.2 / 1.4 / 1.6 / 1.8	2015
200 x 200	1.4 / 1.6 / 1.8 / 2.0	2020
250 x 100	1.4 / 1.6 / 1.8 / 2.0	2510
250 x 150	1.4 / 1.6 / 1.8 / 2.0	2515
250 x 200	1.4 / 1.6 / 1.8 / 2.0	2520
250 x 250	1.4 / 1.6 / 1.8 / 2.0	2525
300 x 100	1.4 / 1.6 / 1.8 / 2.0	3010
300 x 150	1.4 / 1.6 / 1.8 / 2.0	3015
300 x 200	1.4 / 1.6 / 1.8 / 2.0	3020
300 x 300	1.4 / 1.6 / 1.8 / 2.0	3030
400 x 100	1.4 / 1.6 / 1.8 / 2.0	4010
400 x 150	1.4 / 1.6 / 1.8 / 2.0	4015
400 x 200	1.4 / 1.6 / 1.8 / 2.0	4020
400 x 250	1.4 / 1.6 / 1.8 / 2.0	4025
400 x 300	1.4 / 1.6 / 1.8 / 2.0	4030
400 x 400	1.4 / 1.6 / 1.8 / 2.0	4040



**Trunking  
Fitting**  
電線槽配件

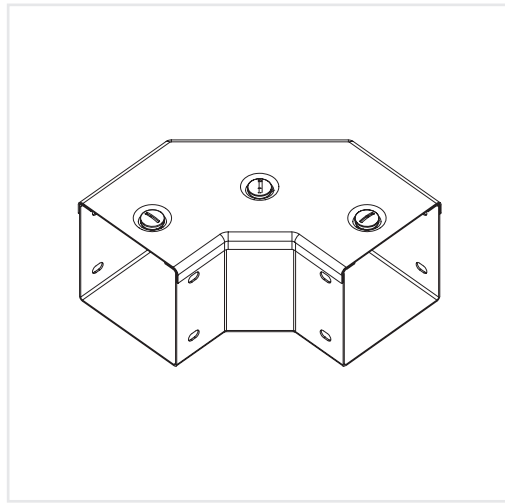

90 degree Front Opening Bend  
(90度 大面曲)  
B + / standard code

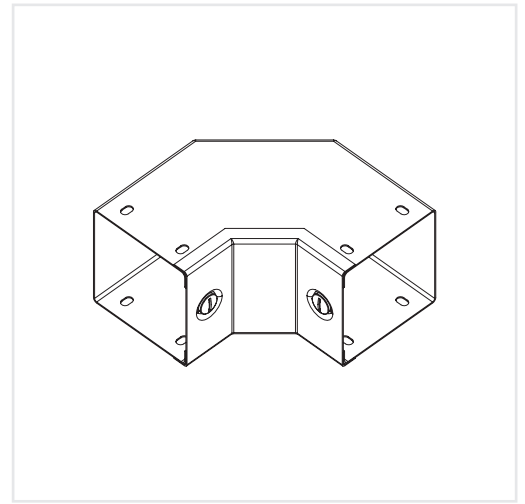

90 degree Internal Opening Bend  
(90度 內曲)  
IB + / standard code

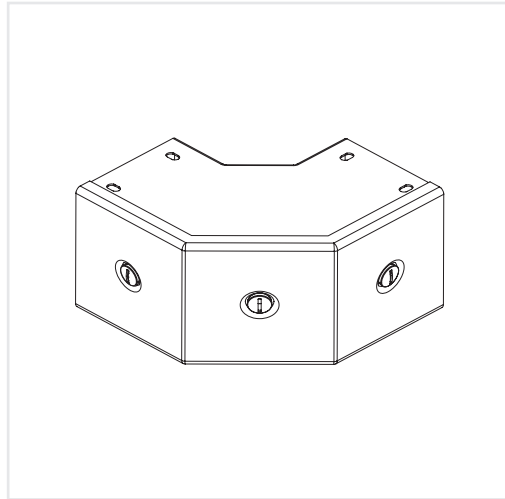

90 degree External Opening Bend  
(90度 外曲)  
EB + / standard code

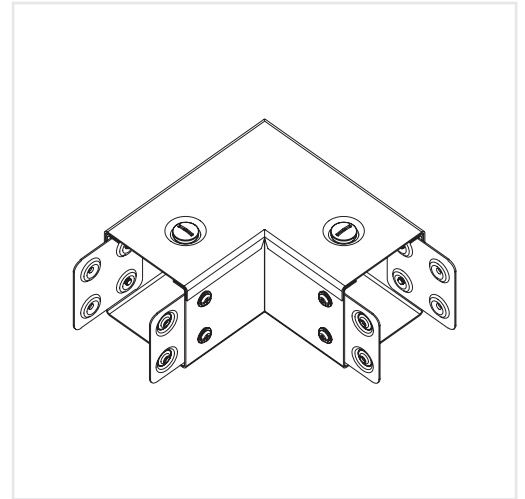

90 degree Front Opening Elbow  
(90度 直角面曲)  
EBF + / standard code

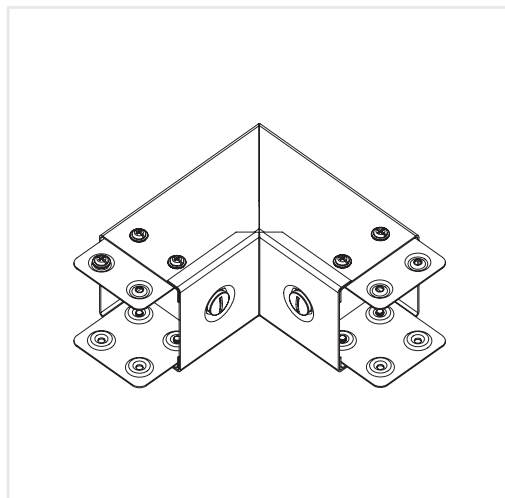

90 degree Internal Opening Elbow  
(90度 直角內曲)  
EBI + / standard code

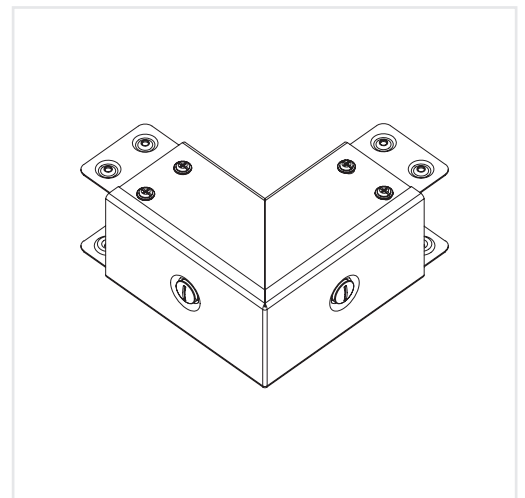

90 degree External Opening Elbow  
(90度 直角外曲)  
EBE + / standard code

Thickness of fittings corresponds to trunking



# Trunking Fitting 電線槽配件

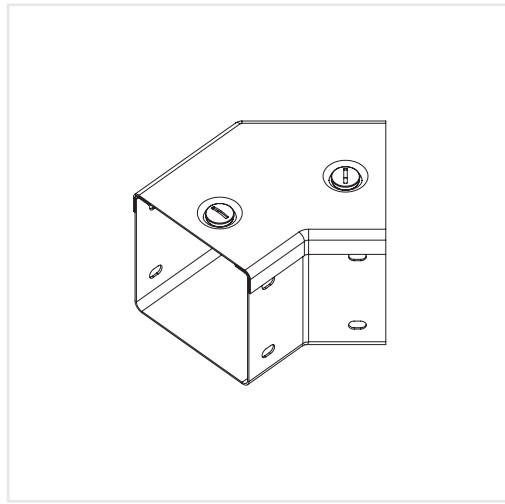

45 degree Front Opening Bend  
(45度 面曲)  
FB + / standard code

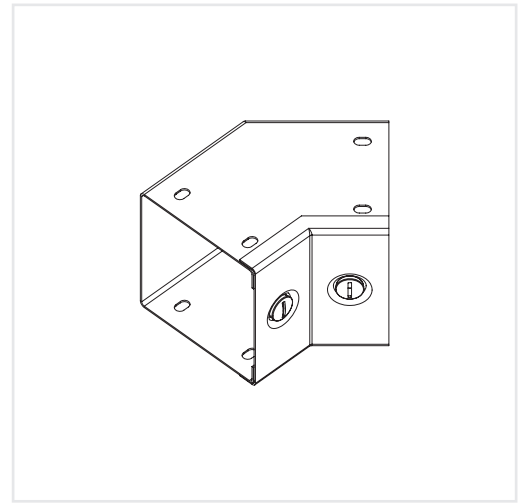

45 degree Internal Opening Bend  
(45度 內曲)  
FIB + / standard code

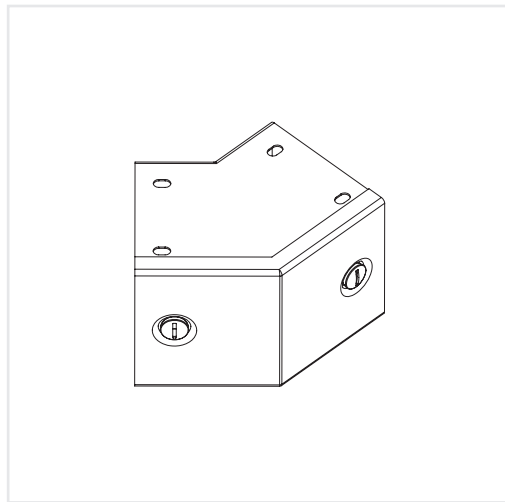

45 degree External Opening Bend  
(45度 外曲)  
FEB + / standard code

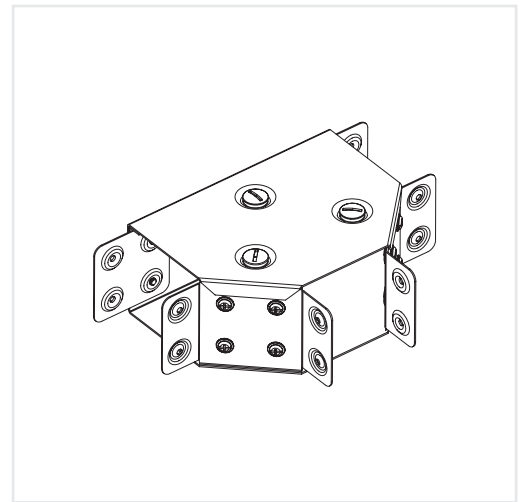

Front Opening Tee  
(大面T)  
T + / standard code

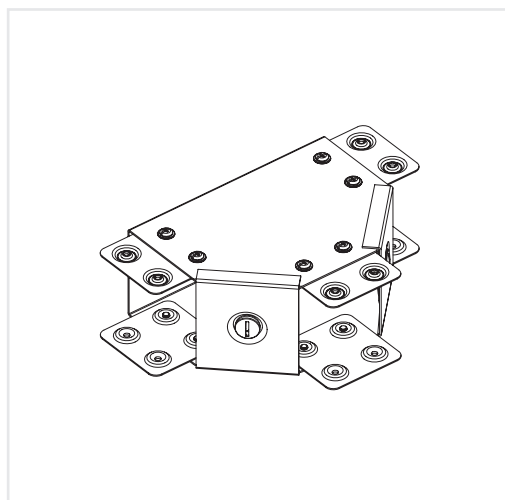

Internal Opening Tee  
(細蓋T)  
IT + / standard code

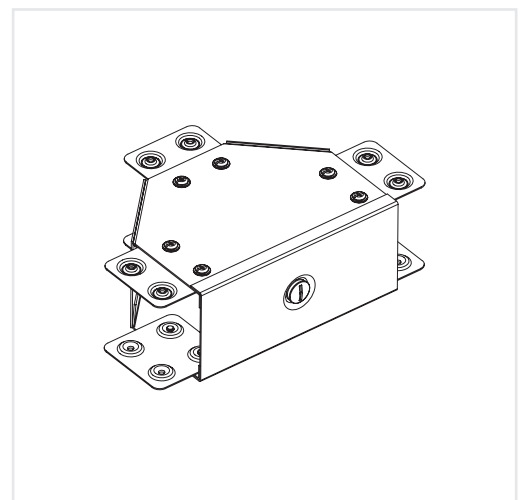

External Opening Tee  
(頂蓋T)  
ET + / standard code



# Trunking Fitting

## 電線槽配件

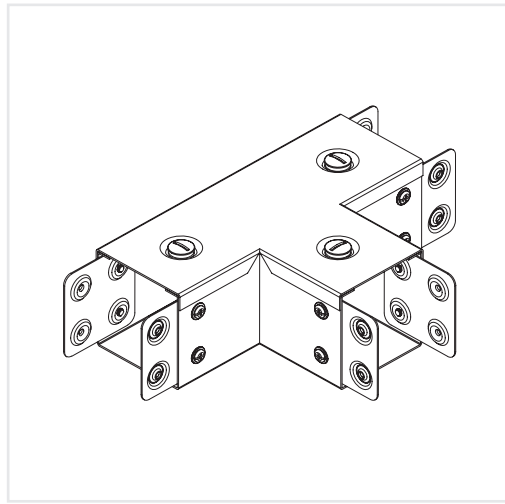

**Front Opening Elbow Tee**  
(直角大面T)  
TTF + / standard code

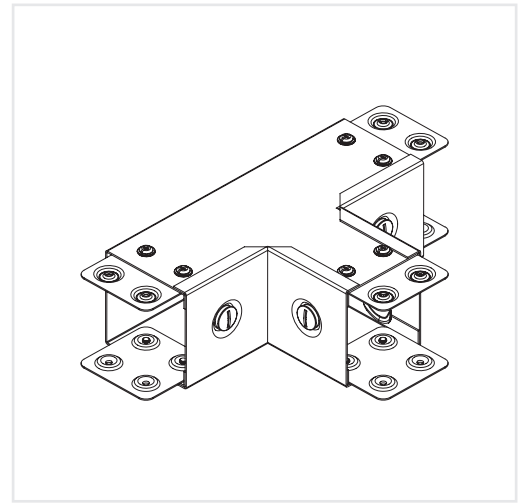

**Internal Opening Elbow Tee**  
(直角細蓋T)  
TTI + / standard code

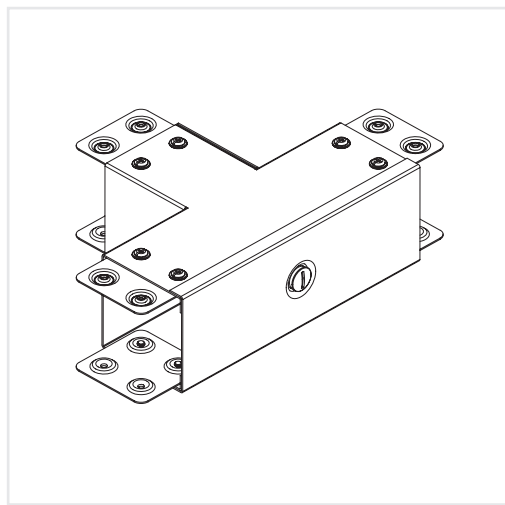

**External Opening Elbow Tee**  
(直角頂蓋T)  
TTE + / standard code

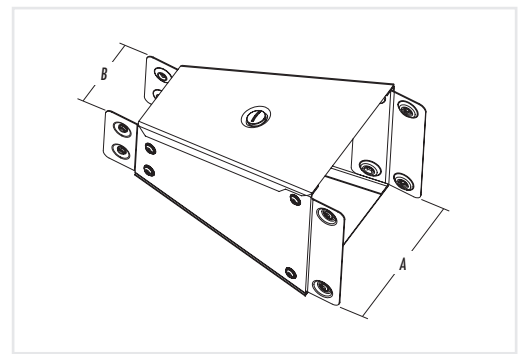

**Reducer (直刁士)**  
+ / size A + / size B

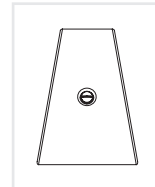

**Centre (KTC)**  
(直刁)

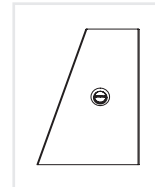

**Left side (KTLH)**  
(左斜)

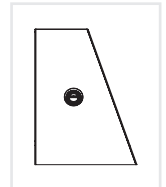

**Right side (KTRH)**  
(右斜)

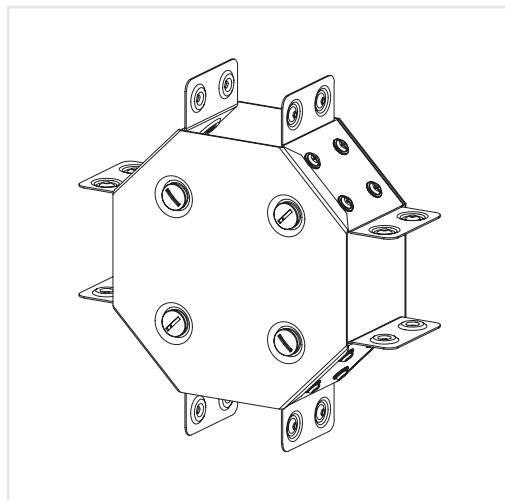

**Front Opening Cross (大面十字)**  
CR + / standard code

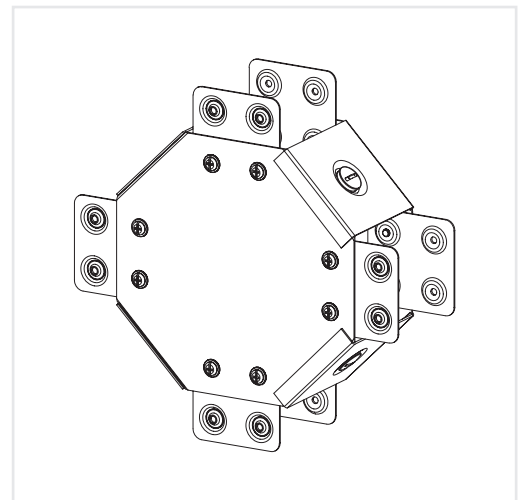

**Outside Opening Cross (細蓋十字)**  
SC + / standard code

**Product Code i.e.:**

100 x 100mm, 1.4mm thk. galvanized steel, spring capped fixed cover trunking  
= KT/1010/SF/1.4/GI

100 x 100mm, 1.4mm thk. galvanized steel, spring capped fixed cover trunking, two-compartment  
= KT/1010/SF/1.4/GI/2C



**Special Trunking  
Fitting  
特製配件**

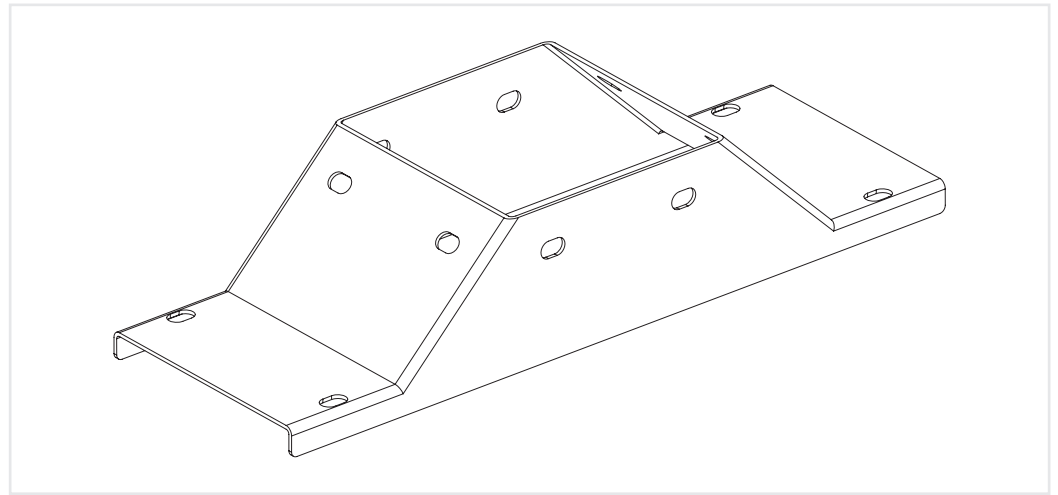

**Cover Tee (直出蓋T)**

Remark: for 2 compartment Cover Tee: Standard Product Code +/ 2

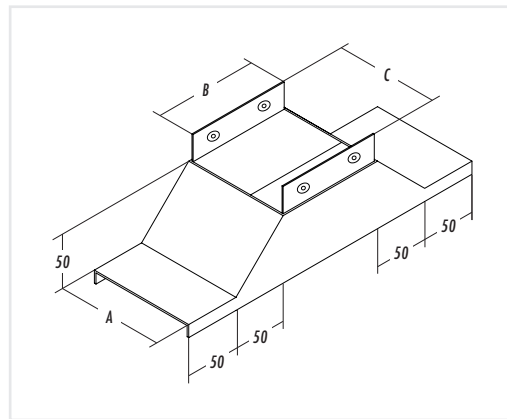

**Type A**

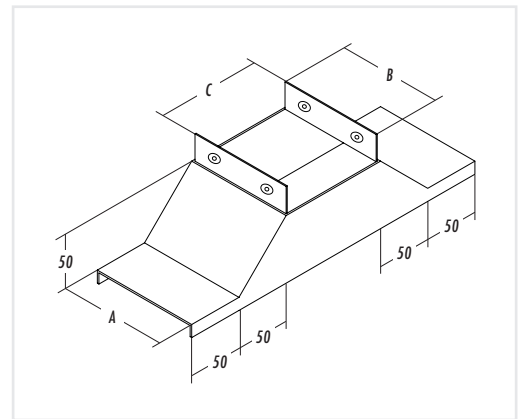

**Type B**

Size in mm A x B x C	Standard Product Code Type A	Standard Product Code Type B
50 x 50 x 50	CTA222	CTB222
75 x 50 x 50	CTA322	CTB322
75 x 50 x 75	CTA323	CTB323
75 x 75 x 75	CTA333	CTB333
100 x 50 x 50	CTA422	CTB422
100 x 50 x 75	CTA423	CTB423
100 x 50 x 100	CTA424	CTB424
100 x 75 x 75	CTA433	CTB433
100 x 75 x 100	CTA434	CTB434
100 x 100 x 100	CTA444	CTB444
150 x 75 x 75	CTA633	CTB633
150 x 75 x 100	CTA634	CTB634
150 x 100 x 100	CTA644	CTB644
150 x 150 x 150	CTA666	CTB666
200 x 75 x 75	CTA833	CTB833
200 x 100 x 100	CTA844	CTB844
200 x 100 x 150	CTA846	CTB846
200 x 100 x 200	CTA848	CTB848
200 x 150 x 200	CTA868	CTB868
200 x 200 x 200	CTA888	CTB888
300 x 150 x 150	CTA1266	CTB1266
300 x 200 x 200	CTA1288	CTB1288
300 x 200 x 300	CTA12812	CTB12812
300 x 300 x 300	CTA121212	CTB121212

Thickness of fitting correspond to trunking



**Special Trunking  
Fitting  
特製配件**

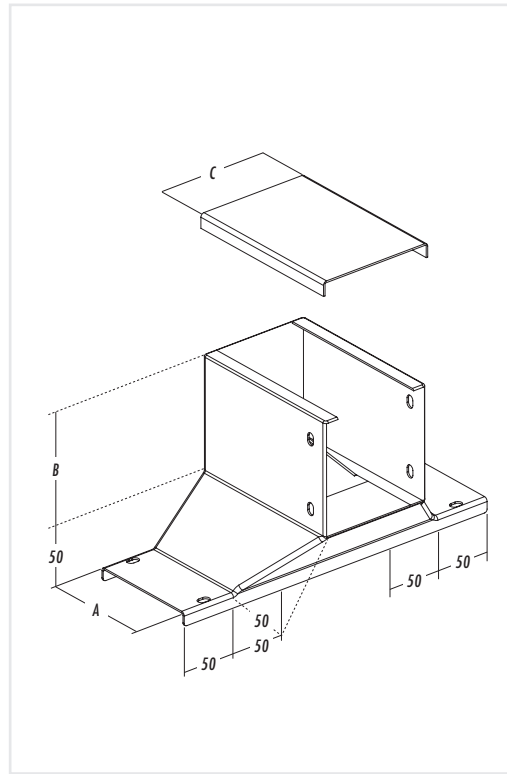

Change Face Cover Tee 轉面槽蓋T

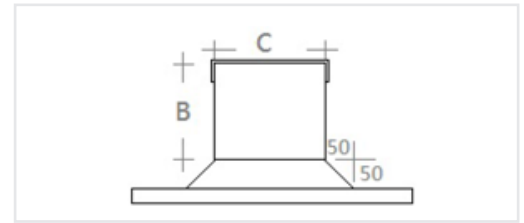

Front 正面 (Type A)

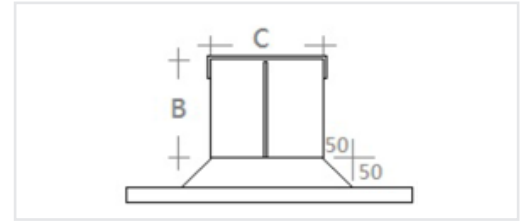

Front 正面 (Type B)

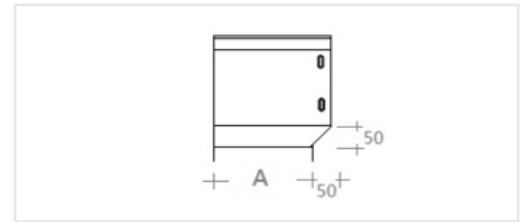

Side 側面 (Type A or B)

Size in mm A x B x C	Standard Product Code for 1/C 單格 Type A	Standard Product Code for 2/C 孖格 Type B
50 x 50 x 50	CFA222	CFB222
75 x 50 x 50	CFA322	CFB322
75 x 50 x 75	CFA323	CFB323
75 x 75 x 75	CFA333	CFB333
100 x 50 x 50	CFA422	CFB422
100 x 50 x 75	CFA423	CFB423
100 x 50 x 100	CFA424	CFB424
100 x 75 x 75	CFA433	CFB433
100 x 75 x 100	CFA434	CFB434
100 x 100 x 100	CFA444	CFB444
150 x 75 x 75	CFA633	CFB633
150 x 75 x 100	CFA634	CFB634
150 x 100 x 100	CFA644	CFB644
150 x 100 x 150	CFA646	CFB646
150 x 150 x 150	CFA666	CFB666
200 x 75 x 75	CFA833	CFB833
200 x 100 x 100	CFA844	CFB844
200 x 100 x 150	CFA846	CFB846
200 x 100 x 200	CFA848	CFB848
200 x 150 x 200	CFA868	CFB868
200 x 200 x 200	CFA888	CFB888
300 x 150 x 150	CFA1266	CFB1266
300 x 200 x 200	CFA1288	CFB1288
300 x 200 x 300	CFA12812	CFB12812
300 x 300 x 300	CFA121212	CFB121212



**Accessories**  
**配件**

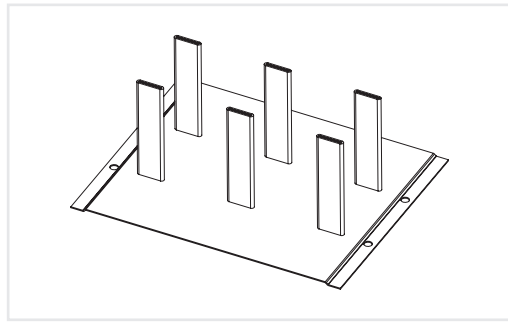

**Pin Rack with Plastic Cover 線掛**  
*DPR / (Size)*

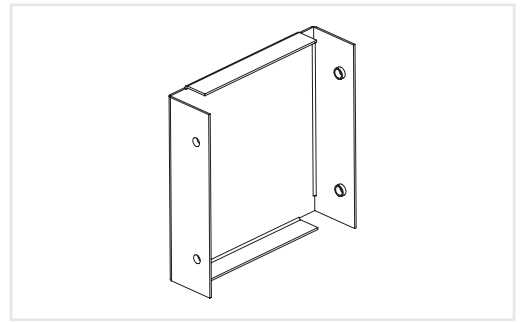

**End Stop 槽尾封**  
*EC / (Size)*

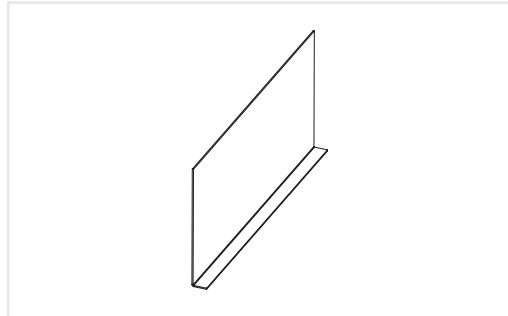

**Divider (1mm) 槽隔片**  
*DIV / (Size)*

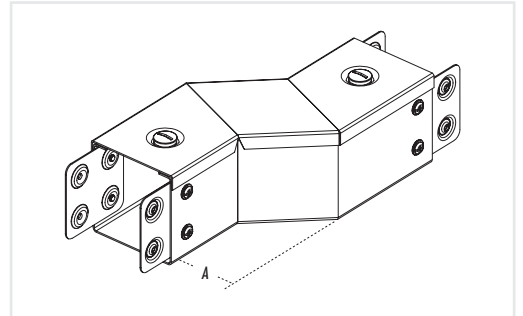

**Horizontal Offset 水平之字**  
*HOR / (Size)*

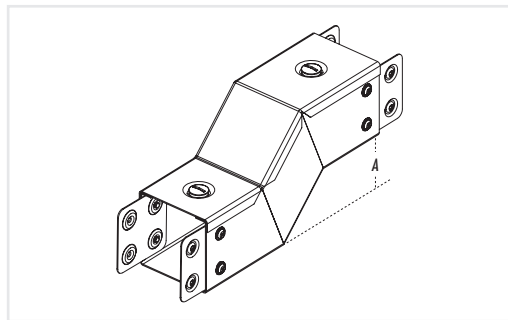

**Vertical Offset 高低之字**  
*VO / (Size)*

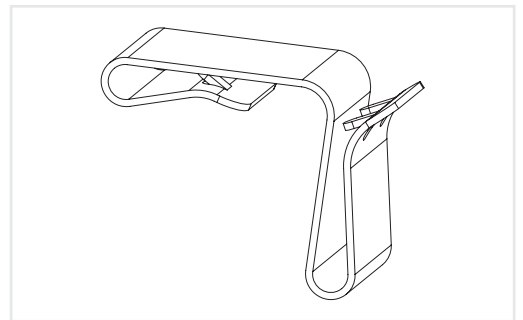

**Spring Cap 槽夾**  
*S / (Size)*

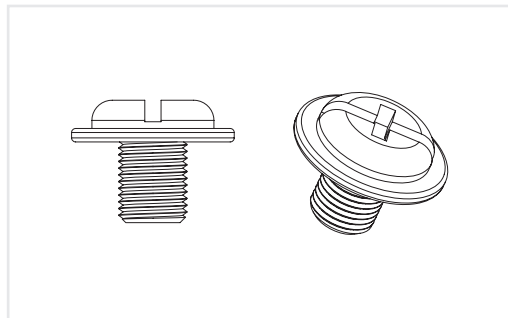

**Flange Screw 槽駁螺絲**  
*KFS / M5 Size or Other Size*

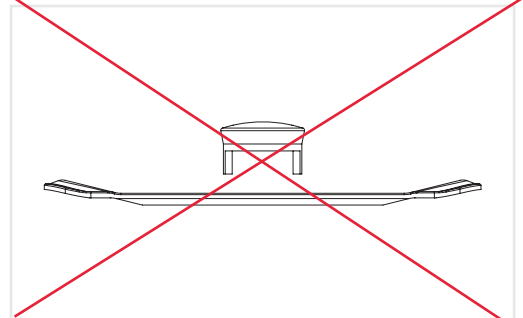

**Quick Fix Bar with Copper Screw 銅頭**  
*Q / (Size)*

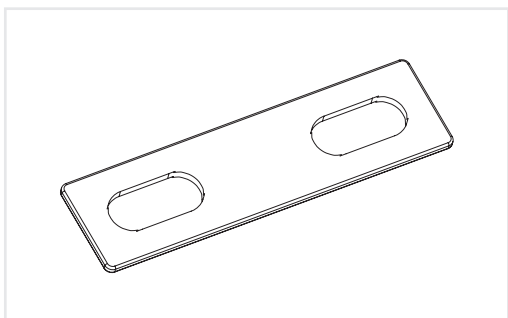

**Copper Earth Link 水線片**  
*COP / (Size)*

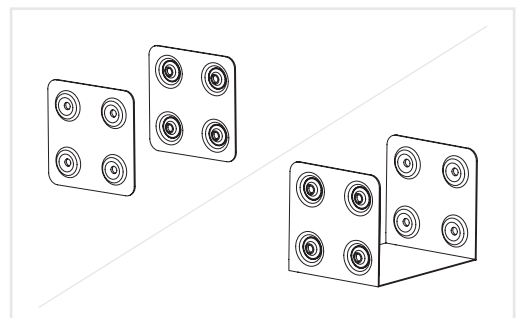

**Trunking Coupler 槽駁片 or U-shaped Connector U型駁口**  
*C / (Size) or UC / (Size)*



# Certificates



香 港 標 準 及 檢 定 中 心

The Hong Kong Standards and Testing Centre

**CERTIFICATE**

**Certificate Number: CFD 0004/2001**

**Issued To:**

**Kam Tai Metal Works Co., Ltd.**  
G/F 397 Po Yip Building  
Sha Tsui Rd  
Tsuen Wan NT

**Declare the product:**

**Description: Cable Trunking with Cover**

**Product Code: KT/5050, KT/7550, KT/7575, KT/1050, KT/1075, KT/1010,  
KT/1550, KT/1575, KT/1510, KT/1515, KT/2010, KT/2250,  
KT/2275, KT/2210, KT/2215, KT/2222, KT/3050, KT/3075,  
KT/3010, KT/3015 & KT/3030**

**Brand Name:**



**Complies with the requirements of the:**

**BS 4678 : Part 1 : Class 3**

**Comply G.S. Clause C2.4**

**General Remarks:**

1. The test was performed in normal operation mode. The test results apply only to the particular sample tested and to the specific test carried out.
2. The certificate applies specifically to the sample tested in our test report reference number HC109692.



**Anne Chuah, CFD**  
**For Managing Director**  
**Date of Issued: 2001-08-03**

**Conditions in issuance of Test Report**

1. This Report is issued in confidence to the client and it will be strictly treated as such by the Hong Kong Standards and Testing Centre Ltd. It may not be reproduced either in its entirety or in part and it may not be used for advertising. The client to whom the Report is issued may, however, show or send it, or a certified copy thereof prepared by the Hong Kong Standards and Testing Centre Ltd. to his customer, supplier or other persons directly concerned. The Hong Kong Standards and Testing Centre Ltd. will not, without the consent of the client, enter into any discussion of correspondence with any third party concerning the contents of the Report. 2. The report refers only to the sample tested and does not apply to the bulk, unless the sampling has been carried out by the Hong Kong Standards and Testing Centre Ltd. and is stated as such in the Report. 3. In the event of the improper use of the report, the Hong Kong Standards and Testing Centre Ltd. reserves the rights to withdraw it, and to adopt any other remedies which may be appropriate. 4. Samples submitted for testing are accepted on the understanding that the Report issued cannot form the basis of, or be the instrument for, any legal action against the Hong Kong Standards and Testing Centre Ltd. 5. The Hong Kong Standards and Testing Centre Ltd. will not be liable for or accept responsibility for any loss or damage howsoever arising from the use of information contained in any of its Reports or in any communication whatsoever about its said tests or investigations. 6. Applicants wishing to use the Report in court proceedings or arbitration shall inform the Hong Kong Standards and Testing Centre Ltd. to that effect prior to submitting the sample for testing.

香港新界大埔工業邨大宏街10號  
**10 Dai Wang Street,**  
**Taipo Industrial Estate,**  
**N. T., Hong Kong**  
**Tel : (852) 2666 1888**  
**Fax : (852) 2664 4353**  
**Homepage: www.hkstc.com**  
**E-mail: hkstc@hkstc.com**

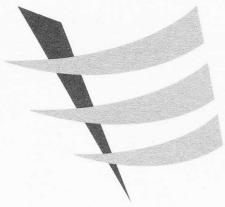

東業德勤測試顧問有限公司  
ETS-TESTCONSULT LIMITED

8/F., Block B, Veristrong Industrial Centre, 34-36 Au Pui Wan Street, Fotan, Hong Kong  
Tel : 2695 8318 E-mail : etl@ets-testconsult.com  
Fax : 2695 3944 Web site : www.ets-testconsult.com

**TEST REPORT**

**Testing of Hot-dip Zinc Coated Steel Plate**

Customer Name : Kam Tai Product (HK) Co Ltd Report Date : 23 December 2010  
Address : G/F, Po Yip Building, 397 Sha Tsui Road, Tsuen Wan, N.T., Hong Kong Report No. : AGA00209  
Lab. Ref. No. : CL/0/G046/02  
Sample Description : Hot-dip zinc coated steel plate Date Received : 14 December 2010  
Designation : BS EN 10143 : 2006 Date Tested : 21 December 2010  
Thk. of Base Metal : 1.2 mm Page No. : 1 of 1  
**Comply G.S. Clause C2.4** Test Method : BS EN 10327 : 2004

**Test Result(s)**

Lab. Ref. No.	Customer's Sample Identification	Test Item	Result
CL/0/G046/02	---	Coating Mass	292 g/m <sup>2</sup>

Remarks : The coating mass of the submitted sample was found to comply with the requirements of designation Z275 of BS EN 10327 : 2004.

Tested By : LEUNG, Ka Ming

Checked By :

Approved Signatory :   
LAU, Chi Leung

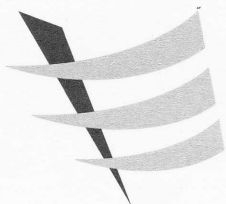

東業德勤測試顧問有限公司  
ETS-TESTCONSULT LIMITED

8/F., Block B, Veristrong Industrial Centre, 34-36 Au Pui Wan Street, Fotan, Hong Kong  
Tel : 2695 8318 E-mail : etl@ets-testconsult.com  
Fax : 2695 3944 Web site : www.ets-testconsult.com

**TEST REPORT**

**Testing of Hot-dip Zinc Coated Steel Sheet**

Customer Name : Kam Tai Product (HK) Co Ltd Report Date : 09 February 2010  
Address : G/F, Po Yip Building, 397 Sha Tsui Road, Tsuen Wan, N.T., Hong Kong Report No. : AGA00015  
Lab. Ref. No. : CL/0/G011/01  
Sample Description : Hot-dip zinc coated steel sheet for cable trunking, cable tray and cable ladder Date Received : 03 February 2010  
Designation : BS EN 10143 : 2006 Date Tested : 06 February 2010  
Thk. of Base Metal : 1.4 mm Page No. : 1 of 1  
**Comply G.S. Clause C2.4** Test Method : BS EN 10327 : 2004

**Test Result(s)**

Lab. Ref. No.	Customer's Sample Identification	Test Item	Result
CL/0/G011/01	---	Coating Mass	306 g/m <sup>2</sup>

Remarks : The coating mass of the submitted sample was found to comply with the requirements of designation Z275 of BS EN 10327 : 2004.

Tested By : LEUNG, Ka Ming

Checked By :

Approved By :   
LAU, Chi Leung  
Chief Chemist



東業德勤測試顧問有限公司  
ETS-TESTCONSULT LIMITED

8/F., Block B, Veristrong Industrial Centre, 34-36 Au Pui Wan Street, Fotan, Hong Kong  
Tel : 2695 8318 E-mail : etl@ets-testconsult.com  
Fax : 2695 3944 Web site : www.ets-testconsult.com

**TEST REPORT**

**Testing of Hot-dip Zinc Coated Steel Sheet**

Customer Name : Kam Tai Product (HK) Co Ltd Report Date : 09 February 2010  
Address : G/F, Po Yip Building, 397 Sha Tsui Road, Tsuen Wan, N.T., Hong Kong Report No. : AGA00016  
Lab. Ref. No. : CL/0/G011/02  
Sample Description : Hot-dip zinc coated steel sheet for cable trunking, cable tray and cable ladder Date Received : 03 February 2010  
Designation : BS EN 10143 : 2006 Date Tested : 06 February 2010  
Thk. of Base Metal : 1.6 mm Page No. : 1 of 1  
**Comply G.S. Clause C2.4** Test Method : BS EN 10327 : 2004

**Test Result(s)**

Lab. Ref. No.	Customer's Sample Identification	Test Item	Result
CL/0/G011/02	---	Coating Mass	296 g/m <sup>2</sup>

Remarks : The coating mass of the submitted sample was found to comply with the requirements of designation Z275 of BS EN 10327 : 2004.

Tested By : LEUNG, Ka Ming

Checked By :

Approved By :   
LAU, Chi Leung  
Chief Chemist

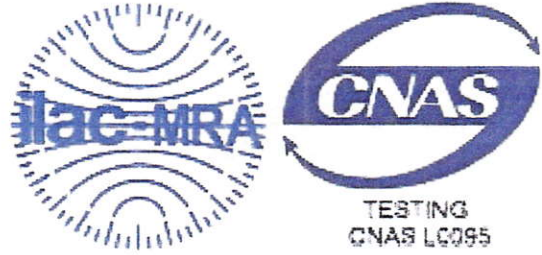

No.:GJW2009-0684

# 检验报告

TEST REPORT

NAME OF SAMPLE: Steel cable trunking

CLIENT: Kam Tai Product (HK) Limited

CLASSIFICATION OF TEST: Commission test

Guangzhou Vkan Certification and Testing Institute (CVC—former GTIHEA)







# 检验报告

## TEST REPORT

No.: GJW2009-0684

Name of product: Steel cable trunking	Trade mark:  K.T.
Type/Model: KT/2050, KT/3050, KT/4050, KT/2075, KT/3075, KT/4075, KT/2010, KT/3010, KT/4010, /2C, /3C, /FB, /FT, /FW, /HB, /JB, /SE, /RB,  KT/5050, KT/7575, KT/1010, KT/1510, KT/1515, KT/2020, /SS, /B, /IB, /EB, /FB, /FIB, /FEB, /T, /IT, /ET,	Sample status: —
Manufacturer: Kam Tai Electrical Product Ltd.	Commissioned by: Kam Tai Product (HK) Limited
Manufacturer address: No.5, Long Feng du tian Industrial Distrct, Huizhou, Gongdong Province, P.R. China	Commissioner address: G/F, 397 Sha Tsul Road, Tsuen Wan, N.T
Quantity of sample: 51 pcs	Sampled by: —
Sample identification: —	Sampling at (place): —
Means of receiving: Submitted by the client	Means of sampling: —
Classification of test: Commission test	Sampling date: —
Receiving date: 2009.07.05	Completing date: 2009.08.13
Tested according to: IEC 61084-1:1991+A1:1993	Test item: Full test
<p>Test conclusion: <span style="border: 1px solid red; padding: 2px;">Comply G.S. Clause C2.4</span></p> <p>The steel cable trunking submitted by the client is tested according to the following standard: IEC 61084-1:1991+A1:1993 <b>Cable trunking and ducting systems for electrical installations</b> <b>Part 1: General requirements.</b></p> <p>Test result: pass.</p> <div style="text-align: right; margin-top: 20px;">             Seal of CVC            Date of issue: 2009.08.13         </div>	

Approved by:



Reviewed by: Meng Zhiqiang

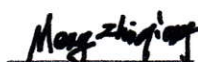

Tested by: Lu Guowei

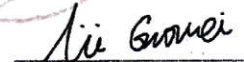



**Test item particulars:**

Material .....: Steel  
Mechanical properties .....: Heavy mechanical stresses  
Temperatures .....: -5°C  
Flame propagation .....: Non-flame propagation  
Electrical characteristics .....: Electrical continuity characteristics  
Protection against external influences  
Protection against ingress of solid objects .....: N  
Protection against ingress of water .....: N  
Protection against corrosive or polluting substances .....: high protection outside and medium protection inside  
Protection against solar radiation .....: Without protection  
Cover retention of the system .....: With tools

**Copy of marking plate:**



**Summary of testing:**

—





東業德勤測試顧問有限公司  
ETS-TESTCONSULT LIMITED

8/F., Block B, Veristrong Industrial Centre, 34-36 Au Pul Wan Street, Fotan, Hong Kong  
Tel : 2695 8318 E-mail : etl@ets-testconsult.com  
Fax : 2695 3944 Web site : www.ets-testconsult.com

**TEST REPORT**

**Testing of Zinc Coating on Steel Bolt, Nut and Washer**

Customer Name : Kam Tai Product (HK) Co Ltd Report Date : 16 March 2011  
Address : G/F, Po Yip Building, 397 Sha Tsui Road, Report No. : AGA10090  
Tsuen Wan, N.T., Hong Kong Lab. Ref. No. : CL/1/G010/01-04  
Sample Description : Zinc coated steel bolt, nut and washer Date Received : 10 March 2011  
Designation : BS 3382:1961 Date Tested : 16 March 2011  
**Comply G.S. Clause C2.4** Page No. : 1 of 1  
Test Method : BS 3382:1961

**Test Result(s)**

Lab. Ref. No.	Customer's Sample Identification	Test Item	Result
CL/1/G010/01	Bolt	Coating Thickness	6.4µm
CL/1/G010/02	Nut	Coating Thickness	6.6µm
CL/1/G010/03	Flat Washer	Coating Thickness	3.4µm
CL/1/G010/04	Spring Washer	Coating Thickness	1.5µm

Remarks : The coating thickness of the submitted bolt and nut samples were found to comply with the requirements of BS 3382:1961.

Tested By : LEUNG, Ka Ming

Checked By : 

Approved By :   
LAU, Chi Leung

# Job Reference



**"K.T." CABLE CONTAINMENT SYSTEM OR U-CHANNEL SUPPORT SYSTEM**

Project Name	Completion Year /	Developer /	Consultant
<b>ASD Project 建築署</b>			
1./ - Liantang/ Heung Yuen Wai Boundary Control Point / 蓮塘/香園圍口岸, SS C505	On Progress		
2./ - West Kowloon Government Offices in Yau Ma Tei / 西九龍政府合署, SS C502	On Progress		JRP
3./ - West Kowloon Cultural District - Xiqu Centre / 西九戲曲中心	On Progress		Burohappold
4./ - Primary School at Pak Fuk Road, North Point, SS D515	On Progress		WSP
5./ - West Wing of the former Central Government Offices / 前中區政府合署西座, RFD514	On Progress		
6./ - Sports Centre in Area 24D, Sha Tin / 沙田體育館, SS C510	On Progress		
7./ - Sport Centre, Community Hall & Football Pitches in Area 1 Tai Po / 大埔運動場	On Progress		
8./ - Girls School at Choi Hing Road, Kwun Tong, Kowloon / 彩興路女童羣育學校, SS C506	2017		
9./ - TKO Fire Services Training School / 將軍澳消防訓練學校, SS A503	2016		Mott MacDonald
10./ - Trade and Industry Tower in Kai Tak Development Area / 啟德工業貿易大樓, SS W304	2015		
11./ - West Kowloon Law Courts Building / 西九龍法院, SS W319	2015		
12./ - Government Logistics Department's Printing Workshop / 柴灣政府物料營運中心, RF B505	2015		
13./ - Disciplined service quarters in Fu Tei, Tuen Mun / 屯門紀律部隊宿舍, SS A511	2015		
14./ - Tai Lam Centre for Women / 大欖女懲教所, SS W326	2015		
15./ - Construction of an Annex Building for Ko Shan Theatre / 高山劇場, SS X302	2014		
16./ - Cruise Terminal Building / 啟德郵輪碼頭, SS W303	2013		AECOM
<b>Hospital Authority 醫院管理局</b>			
1./ - Establishment of the Centre of Excellence in Paediatrics / 兒童專科卓越醫療中心, SS A501	On Progress		
2./ - Kwai Chung Hospital Phase 1 / 葵涌醫院, SS D501	On Progress		
3./ - Expansion of Haven of Hope Hospital / 靈實醫院擴建	On Progress		AECOM
4./ - Yaumatei Specialist Clinic at Queen Elizabeth Hospital / 伊利沙伯油麻地專科診所, SSB502	2017		AECOM

**金泰製品(香港)有限公司**

香港新界荃灣德士古道148號隆盛工廠大廈地下  
G/F, LUNG SHING FACTORY BLDG., 148 TEXACO ROAD, TSUEN WAN, N.T., HKSAR  
TEL: (852) 2490 4615 FAX: (852) 2413 4117  
http://www.ktp-hk.com E-mail: cs@ktp-hk.com





**"K.T." CABLE CONTAINMENT SYSTEM OR U-CHANNEL SUPPORT SYSTEM**

Project Name	Completion Year /	Developer /	Consultant
5./ - Expansion of TKO Hospital / 將軍澳醫院改建改善工程, TCY311 (Term Contract)	2017		
<b>Highways Department Project 路政署</b>			
1./ - Remaining Ancillary Buildings and Facilities at HKZMB / 港珠澳大橋香港口岸-輔助設施, HY/2014/05	On Progress		AECOM
2./ - Remaining Ancillary Building & Facilities at HKZMB / 港珠澳大橋香港口岸-輔助設施, HY/2013/03	On Progress		AECOM
3./ - Passenger Clearance Building at HKZMB / 港珠澳大橋香港口岸-旅檢大樓, HY/2013/01	On Progress		AECOM
4./ - Hong Kong Link Road - Section Between Scenic Hill & HKBCF/ 港珠澳大橋-觀景山段, HY/2011/03	On Progress		AECOM
5./ - Traffic Control and Surveillance System at HKZMB / 港珠澳大橋 - 交通管制及監察系統, HY/2013/05	On Progress		AECOM
6./ - Tunnel Building at Central - Wan Chai Bypass / 中環灣仔繞道-隧道大樓, HY/2011/08	On Progress		AECOM
<b>EMSD / DSD / WSD / EPD Project 機電工程署 / 渠務署 / 水務署 / 環保署</b>			
1./ - Tai Po Water Treatment Works & Ancillary Facilities / 大埔濾水廠, 15/WSD/10	On Progress	WSD	
2./ - Shatin Water Treatment Works / 沙田濾水廠, 3/WSD/15	On Progress	WSD	
3./ - Organic Waste Treatment Facilities Phase 1 / 有機資源回收中心第1期, EP/SP/61/10	2017	EPD	
4./ - Ngau Tam Mei Water Treatment Works / 牛潭尾濾水廠	2017	WSD	
5./ - Replacement of Lighting System at the Aberdeen Tunnel / 香港仔隧道照明系統, 1007EM12W	2015	EMSD	
<b>CEDD Project 土木工程拓展署</b>			
1./ - Liantang / Heung Yuen Wai Boundary Control Point/ 蓮塘隧道及通風樓, CV/2012/08	On Progress	CEDD	AECOM
2./ - Kai Tak Development - Stage 3A / 啟德發展計劃- 前北面停機坪第3A, KL/2012/02	2017	CEDD	
<b>Hong Kong Housing Authority / Housing Society Project 香港房屋署 / 香港房屋協會</b>			
1./ - Public Rental Housing Development at Lai Chi Kok Road-Tonkin Street Phases 1&2 / 20150259	On Progress	房屋署	
2./ - Public Rental Housing Development at Fo Tan (In Sha Tin Areas 16 & 58D) Phases 1&2 / 20150597	On Progress	房屋署	

金泰製品(香港)有限公司

香港新界荃灣德士古道148號隆盛工廠大廈地下  
G/F, LUNG SHING FACTORY BLDG., 148 TEXACO ROAD, TSUEN WAN, N.T., HKSAR  
TEL: (852) 2490 4615 FAX: (852) 2413 4117  
http://www.ktp-hk.com E-mail: cs@ktp-hk.com



**"K.T." CABLE CONTAINMENT SYSTEM OR U-CHANNEL SUPPORT SYSTEM**

Project Name	Completion Year /	Developer /	Consultant
3./ - Public Rental Housing Development at Shek Kip Mei Estate Phase 3,6&7 / 20150611	On Progress	房屋署	
4./ - Public Rental Housing Development at Choi Yuen Road Sites 3&4, Sheung Shui / 20150364	On Progress	房屋署	
5./ - Home Ownership Scheme Development at Choi Hing Road / 20150248)	On Progress	房屋署	
6./ - Public Housing at Cheung Sha Wan Wholesales Food Market Site 3&5 Phase 1&2 / 20150055	On Progress	房屋署	
7./ - Public Rental Housing at Ex-Kwai Chung Police Married Quarters / 20140301	On Progress	房屋署	
8./ - So Uk Estate Phase 2 & Lin Shing Road, Chai Wan	On Progress	房屋署	
9./ - Public Rental Housing Development at Anderson Road Site A & B Phase 1 & 2	On Progress	房屋署	
10./ - HOS Developments at Sha Tsui Road, Tsuen Wan and Ching Hong Road, Tsing Yi	2017	房屋署	
11./ - Public Rental Housing Development at Tuen Mun Area 54 Site 2 Phase 1 & 2	2017	房屋署	
12./ - Public Rental Housing Development at Anderson Road Site D / 20120164	2016	房屋署	
13./ - Public Rental Housing Development at Anderson Road Site E Phase 1 & 2 / 20120048	2016	房屋署	
14./ - Public Rental Housing Development at Sha Tin Area 52 Phase 2 / 20110039	2016	房屋署	
15./ - Public Rental Housing Development at Sha Tin Area 52 Phase 3 & 4 / 20120263	2016	房屋署	
16./ - Public Rental Housing at Ex-Au Tau Department Quarters at Yuen Long / 20120746	2016	房屋署	
17./ - Public Rental Housing Development at Hung Shui Kiu Area 13 Phase 1 & 2 / 20120095	2014	房屋署	
18./ - Public Rental Housing Development at Tung Tau Cottage Area East / 20100083	2014	房屋署	

**URA Project 市區重建局**

1./ - URA Project MK/01 Proposed Conservation & Revitalization Works at 600-626 Shanghai Street, Mongkok	On Progress		Far East
2./ - URA Project TKW/1/002 Ma Tau Wai Road/ Chun Tin Street, Kowloon	On Progress		
3./ - URA Project TKW/1/001 42A-44 Chi Kiang Street, To Kwa Wan, Kowloon	2017		

**Airport Authority Project 機場管理局**

1./ - Contract P561, North Commercial District Enabling Work / 機場北商業區	On Progress		
---	-------------	--	--

**金泰製品(香港)有限公司**

香港新界荃灣德士古道148號隆盛工廠大廈地下  
G/F, LUNG SHING FACTORY BLDG., 148 TEXACO ROAD, TSUEN WAN, N.T., HKSAR  
TEL: (852) 2490 4615 FAX: (852) 2413 4117  
http://www.ktp-hk.com E-mail: cs@ktp-hk.com



**"K.T." CABLE CONTAINMENT SYSTEM OR U-CHANNEL SUPPORT SYSTEM**

Project Name	Completion Year /	Developer /	Consultant
2./ - Contract C16W004, Baggage Handling System / 機場行李輸送系統	On Progress		
3./ - Contract P533, Midfield Concourse Works / 機場中場擴展	2016		
4./ - Contract P535, Western Hall Modification Works / 西翼大堂改善工程	2014		
5./ - Contract P546, Western Apron Expansions / 機場西區停機坪擴展	2014		
<b>MTRC Project 港鐵</b>			
1./ - Contract 11209, Platform Modification & Associated Works / 東鐵綫車站月台改善工程	On Progress		
2./ - Contract 845, Traction Power Supply System / 廣深港高鐵綫 - 供電系統	On Progress		
3./ - Contract 843, Tunnel Environmental Control System / 廣深港高鐵綫 - 隧道環境控制系統	On Progress		
4./ - Contract 1101, Shatin to Central Link / 沙中綫 - 馬鞍山綫改善工程	2016		
5./ - Contract 965A, South Island Line / 南港島綫 - 香港公園,南風隧道,海洋公園,利東&海怡半島站	2016		
6./ - Contract 965B, South Island Line / 南港島綫 - 黃竹坑站	2016		
7./ - Contract 965C, South Island Line / 南港島綫 - 金鐘站	2016		
8./ - Contract 771, HKU Station, West Island Line / 西港島綫 - 香港大學站	2015		
9./ - Contract 755, West Island Line / 西港島綫 - 供電系統	2015		
10./ - Contract 1001, Yau Ma Tei to Whampoa Tunnels / 觀塘綫延綫 - 隧道及何文田站工程	2014		
<b>College &amp; University Project 學院及大學</b>			
1./ - Malvern College Hong Kong Campus at Area 4, Fo Chun Road, Tai Po / 墨爾文學校	On Progress		P&T
2./ - Shrewsbury International School in Hong Kong	On Progress		P&T
3./ - Ying Wa Girl' School at Robinson Road & 2 Breezy Bath, Hong Kong / 英華女書院	On Progress		P&T
4./ - Phase 3 Harrow International School Extension at Tuen Mun / 哈羅香港國際學校三期	On Progress		
5./ - The International Culinary Institute at Pok Fu Lam Road for VTC / 香港國際廚藝學院	On Progress		WSP-PB
6./ - Shue Yan University, North Point, Hong Kong / 香港樹仁大學	2016		

**金泰製品(香港)有限公司**

香港新界荃灣德士古道148號隆盛工廠大廈地下  
G/F, LUNG SHING FACTORY BLDG., 148 TEXACO ROAD, TSUEN WAN, N.T., HKSAR  
TEL: (852) 2490 4615 FAX: (852) 2413 4117  
http://www.ktp-hk.com E-mial: cs@ktp-hk.com





# KAM TAI

PRODUCT (H.K.) CO., LTD.

## JOB REFERENCE

Date : Mar-2018  
Our Ref. : KT/JR/2008

### "K.T." CABLE CONTAINMENT SYSTEM OR U-CHANNEL SUPPORT SYSTEM

Project Name	Completion Year /	Developer /	Consultant
<b>Macau Project 澳門</b>			
1./ - 澳門輕軌車廠上蓋建造工程 (C385R)	On Progress	Macau Gov.	
2./ - 澳門輕軌鐵路 (C350)	On Progress	Macau Gov.	
3./ - 澳門輕軌鐵路 (C360)	On Progress	Macau Gov.	
4./ - 澳門輕軌鐵路 (C370)	On Progress	Macau Gov.	
5./ - 北安01地段政府綜合服務大樓 建造工程	On Progress		
6./ - 澳門筷子基鄰近俾若翰街C地段住宅發展項目	On Progress		
7./ - 氹仔聚龍街公共房屋建造工程	2016	GDI	
8./ - 澳門珠澳跨境工業區B2a地段-工業倉庫樓宇	2016		
9./ - 氹仔東北馬路公共房屋	2016	GDI	Consulasia
10./ - 澳門美高梅路氹 / MGM Podium & Hotel Development, Cotai, Macau	2016		JBA
11./ - 澳門新濠影匯星麗門 / Studio City at Cotai, Macau	2016		
12./ - 澳門青洲公共房屋	2016	Macau Gov.	
13./ - 澳門大學	2015		
14./ - 澳門銀河 2期 / Galaxy Phase 2	2014	GEG	WSP-PB
15./ - 澳門石排灣公共房屋CN5a地段社會設施裝修工程	2014		
<b>Data Center 數據中心</b>			
1./ - Global Switch Hong Kong - Building 4 & 5	On Progress	Global Switch	Aurecon
2./ - Global Switch Hong Kong - Building 3	On Progress	Global Switch	Aurecon
3./ - Global Switch Hong Kong - Building 1 & 2	2017	Global Switch	Aurecon
4./ - Hang Sang Data Center at 113-115 Argyle Street / 恆生銀行數據中心	2016	恆生銀行	WOY
5./ - HSBC Data Centre at Shatin / 沙田匯豐數據中心	2014	匯豐銀行	

#### 金泰製品(香港)有限公司

香港新界荃灣德士古道148號隆盛工廠大廈地下  
G/F, LUNG SHING FACTORY BLDG., 148 TEXACO ROAD, TSUEN WAN, N.T., HKSAR  
TEL: (852) 2490 4615 FAX: (852) 2413 4117  
http://www.ktp-hk.com E-mail: cs@ktp-hk.com





**"K.T." CABLE CONTAINMENT SYSTEM OR U-CHANNEL SUPPORT SYSTEM**

Project Name	Completion Year /	Developer /	Consultant
<b>Commercial Project 私人物業發展</b>			
1./ - DD221 Sai Kung Hotel / 西貢海傍酒店	On Progress		WSP
2./ - The Ocean Park Hotel Marriott Hotel / 海洋公園酒店	On Progress	麗新發展	AECOM
3./ - Proposed Retail & Hotel Development at Tung Chung / 東涌酒店	On Progress	新世界/地鐵/太古	ARUP
4./ - Proposed Residential Development at Oil Street, North Point / 北角油街酒店	On Progress	長實	Meinhardt
5./ - Proposed LOHAS Park IV at Tko Area 86/ 日出康城4期	On Progress	新鴻基	
6./ - West Rail Nam Cheong Station Property Development / 匯璽	On Progress	新鴻基	
7./ - Hotel Development at 97 How Ming Street, Kwun Tong, Kowloon / 觀塘巧明街酒店	On Progress	旭日集團	WOY
8./ - YOHO Town Phase 3, Yuen Long / Grand YOHO	On Progress	新鴻基	
9./ - Ocean Terminal Extension at Tsim Sha Tsui / 海運大廈擴建	On Progress	九龍倉	JRP
10./ - New World Center Remodeling H2	On Progress	新世界	WSP-PB
11./ - New World Center Remodeling H3	On Progress	新世界	WSP-PB
12./ - Proposed Residential Development at STTL 574, Lok Wo Sha, Ma On Shan / 馬鞍山落禾沙	2017	長實	
13./ - K.I.L. No.11175 , Ho Man Tin, Kowloon/ 天鑄Ultima	2017	新鴻基	
14./ - Area 66C1 at Tseung Kwan O / 天晉IIIB期	2017	新鴻基	
15./ - Area 66A at Tseung Kwan O / 天晉IIIA期	2017	新鴻基	
16./ - Tung Chung T.C.T.L. 36 Area 55A / 東環	2016	新鴻基	
17./ - Ha Yau Tin Phase 2 at Yuen Long / 譽88	2016	新鴻基	
18./ - Hong Kong Jockey Club Shatin Communications & Technology Centre	2015	香港賽馬會	SunLand
19./ - Office Development at No. 41 Heung Yip Road, Wong Chuk Hang, AIL 354 Hong Kong	2015	長實	Meinhardt
20./ - Proposed Residential Development at Fung Yuen, Tai Po, T.I.T.L.183 / 嵐山	2015	長實	
21./ - New Hong Kong Red Cross Headquarters at Hit Ting Road, Kowloon / 香港紅十字會總部	2015	香港紅十字會	
22./ - The Development of 28 Hennessy Road / 灣仔軒尼詩道28號	2014	太古地產	